

Pressure gauge DN 100 vertical connection with glycerin (1/2" BSP)

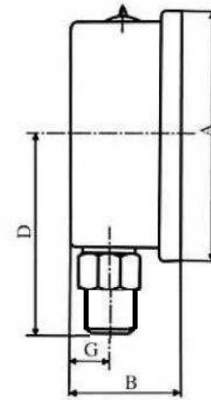
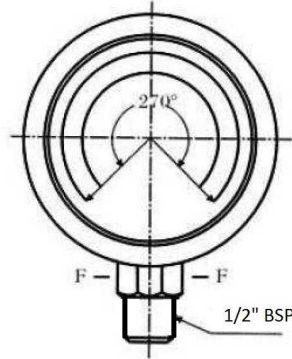

Accuracy: 1,6%

Dimensions: A=109
 B=35,5
 D=74
 F=HEX 14
 G=11,5

Temperature: from -20 up to +60

Material: Case: stainless steel 304
 Ring: stainless steel 304
 Window: polycarbonate (glass)
 Socket & Connection: brass

Part nº	R1	Scale (bar)
MFI10008001V	1/2" BSP	0-1
MFI1000802.5V	1/2" BSP	0-2.5
MFI10008004V	1/2" BSP	0-4
MFI10008006V	1/2" BSP	0-6
MFI10008010V	1/2" BSP	0-10
MFI10008012V	1/2" BSP	0-12
MFI10008016V	1/2" BSP	0-16
MFI10008020V	1/2" BSP	0-20
MFI10008025V	1/2" BSP	0-25
MFI10008040V	1/2" BSP	0-40
MFI10008060V	1/2" BSP	0-60
MFI10008100V	1/2" BSP	0-100
MFI10008160V	1/2" BSP	0-160
MFI10008250V	1/2" BSP	0-250
MFI10008315V	1/2" BSP	0-315
MFI10008400V	1/2" BSP	0-400
MFI10008600V	1/2" BSP	0-600

The information gathered in this technical documentation (Catalogue) has an informative character and can be modified without previous notice. DICSQA will not accept any type of responsibility resulting from an inappropriate use of the product, except the ones related to manufacturing defects.

Pressure gauge DN 100 vertical connection with glycerin (1/2" BSP)

2/2

Part n°	R1	Scale (bar)
MFI100081000V	1/2" BSP	0-1000

***** Review attached PDF*****

With dual bar/psi scale

IP65